

cloud softlight · medium mobile · 220-240V hardwire type installation (EU)

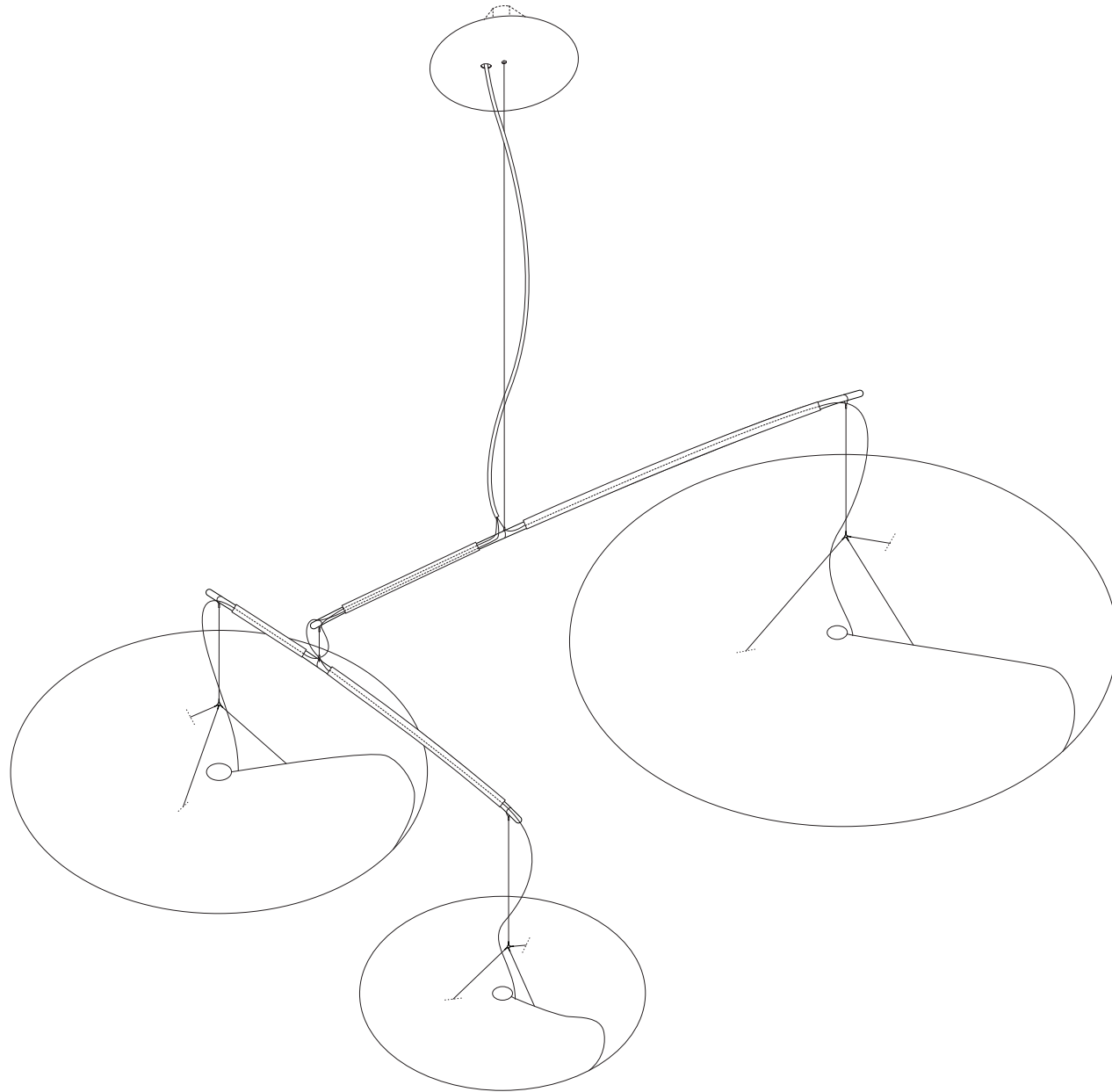

molo

anatomy of medium cloud mobile · 220-240V hardwire type (EU)

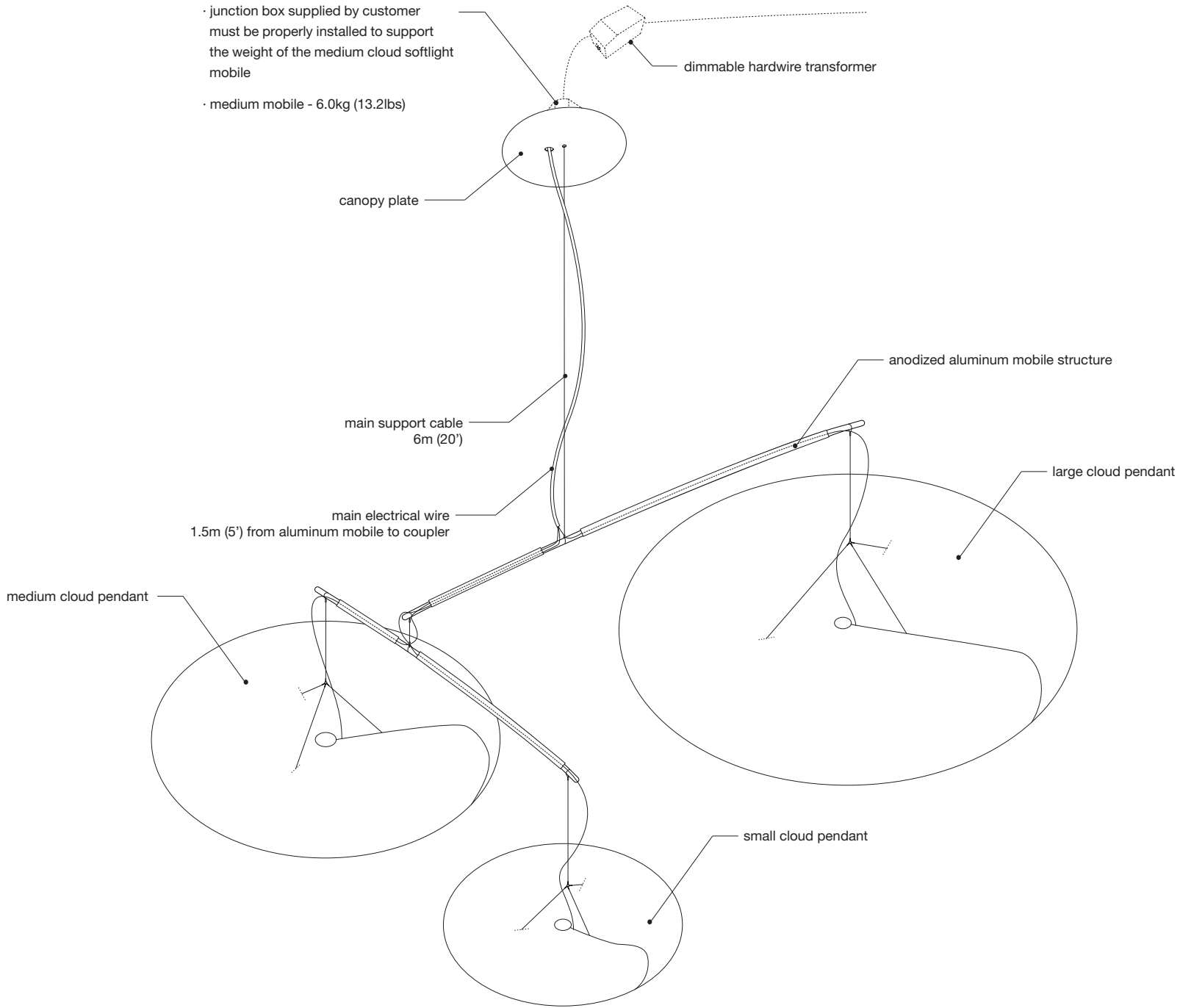

parts of medium cloud mobile · 220-240V hardwire type (EU)

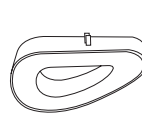
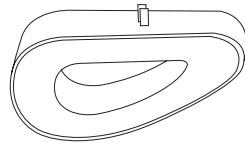
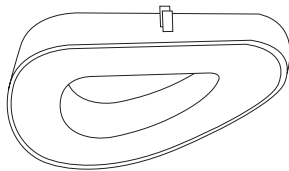
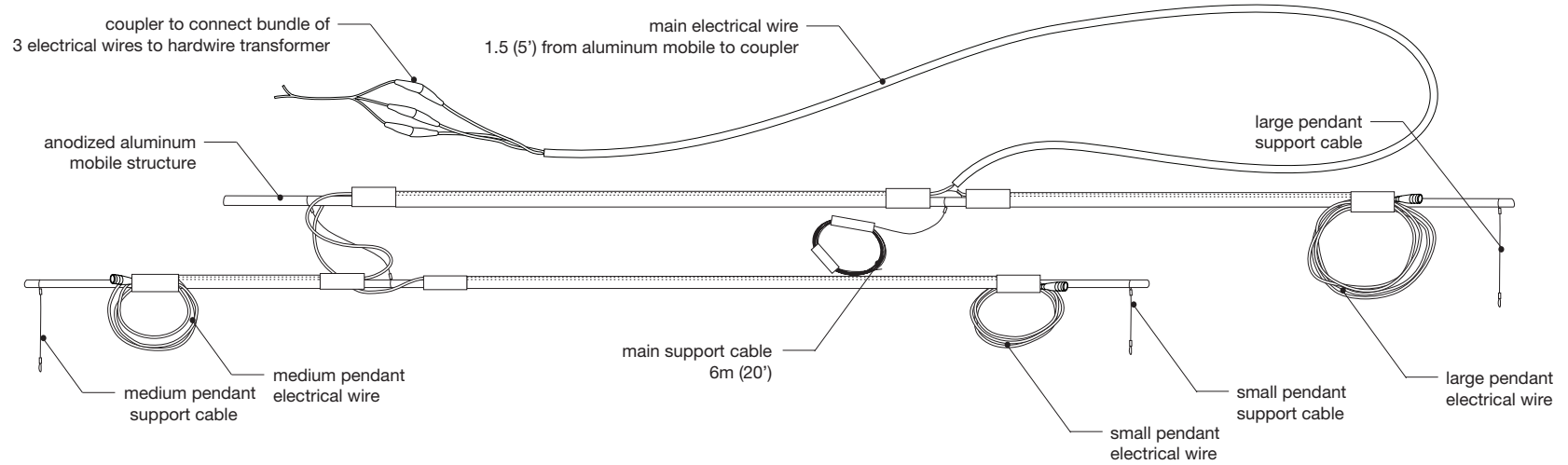

cloud shade
sm, md, lg
(compressed for shipping)

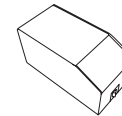

dimmable hardwire transformer
176mm x 86mm x 38mm
(7" x 3^{3/8}" x 3^{3/8}")



bracket bar with cable gripper

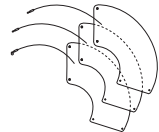
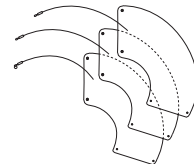
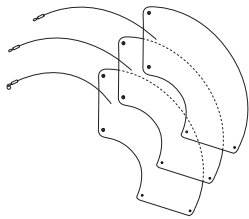

shade armature
sm, md, lg
(with chicago bolts)



split ring pliers



alternate 'ring type' cable gripper (flexible option of hanging cloud pendants from wall hooks)

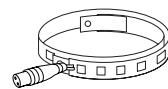
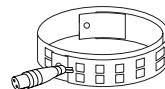
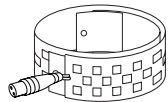

LED ribbon
sm, md, lg

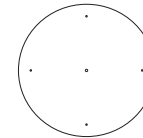
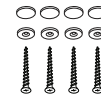

230mm (11") canopy plate, installation template, & mounting magnets/hardware

anatomy of cloud pendant within mobile

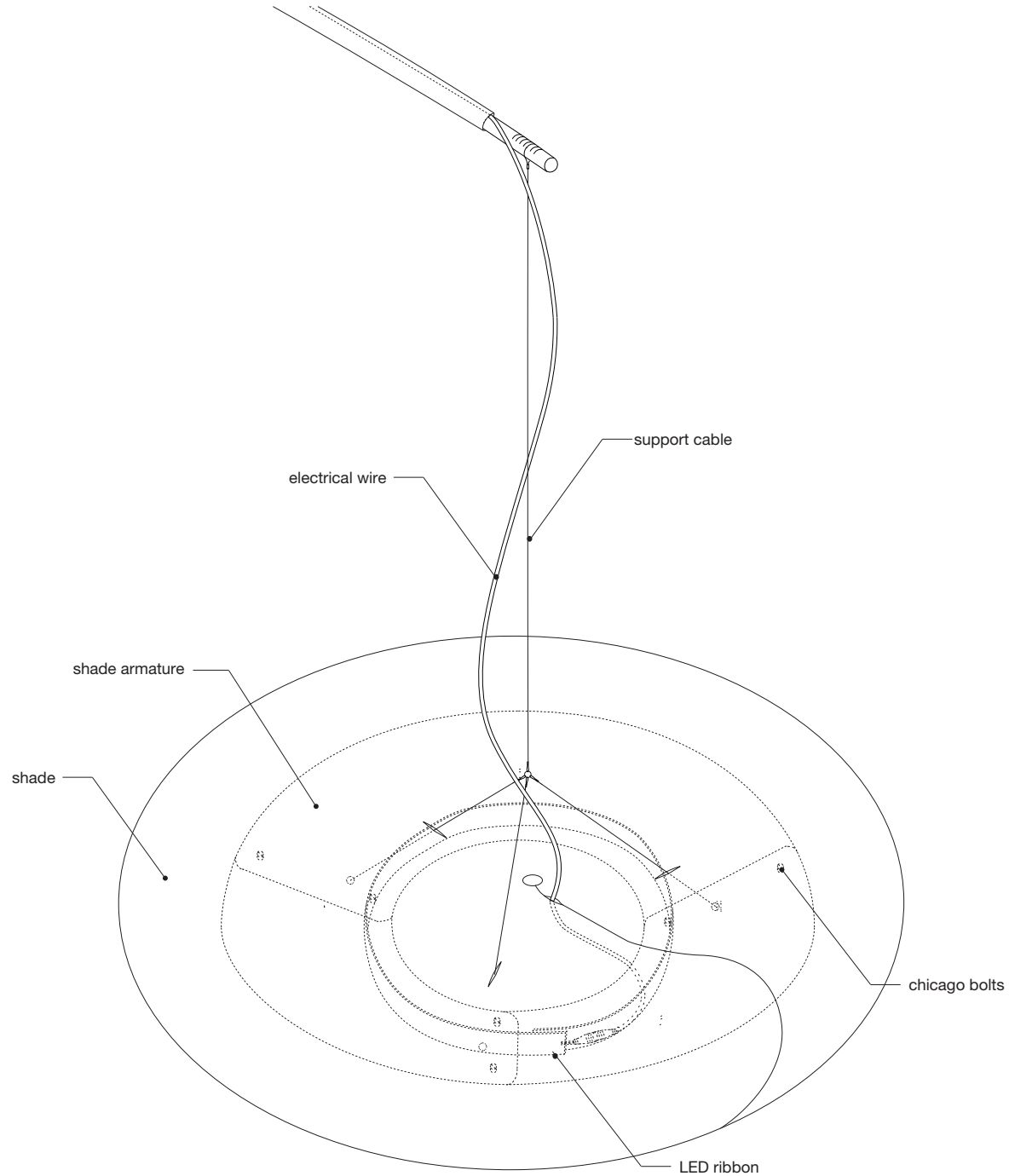

assembling cloud pendant

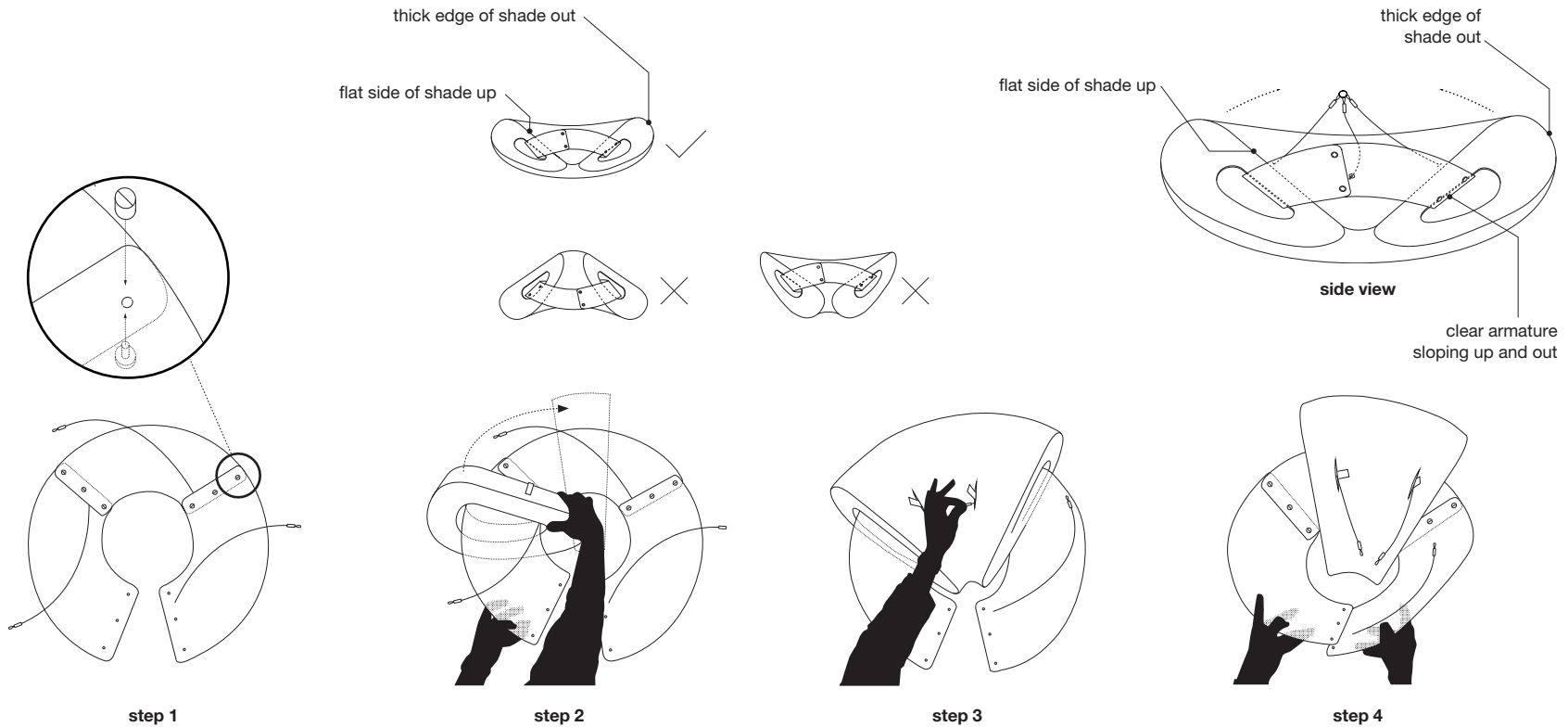

step 1: To assemble cloud armature, peel off protective paper and lay all three clear plastic pieces on a table. Be sure steel support cables with crimped loop end are on top side. Unscrew chicago bolts (hand turn), line up holes of armature as shown above and screw together to create a "c" shaped collar (do not close collar at this time).

step 2: Feed armature through shade cavity. Flat side of shade should face up with thick edge of shade at outer perimeter.

IMPORTANT: If this step is not done correctly you will end up with a "droopy" looking cloud. Be sure the clear plastic armature forms a truncated cone shape with the larger diameter facing up and the center of the cone pointing down as shown in the drawing above on right side of page. Also note the orientation of cloud shade shape shown above, with flat side on top and smaller pointed end toward the center.

step 3: Feed two support cables through the larger cells of the shade. The larger cells are marked with coloured tags.

step 4: Line up the holes of the last set of connection points in plastic armature. Start with the holes closest to the center, screw together. By lifting the outside perimeter of armature you will create a truncated cone that slopes down to the center. Screw in the last chicago bolts.

assembling cloud pendant within mobile

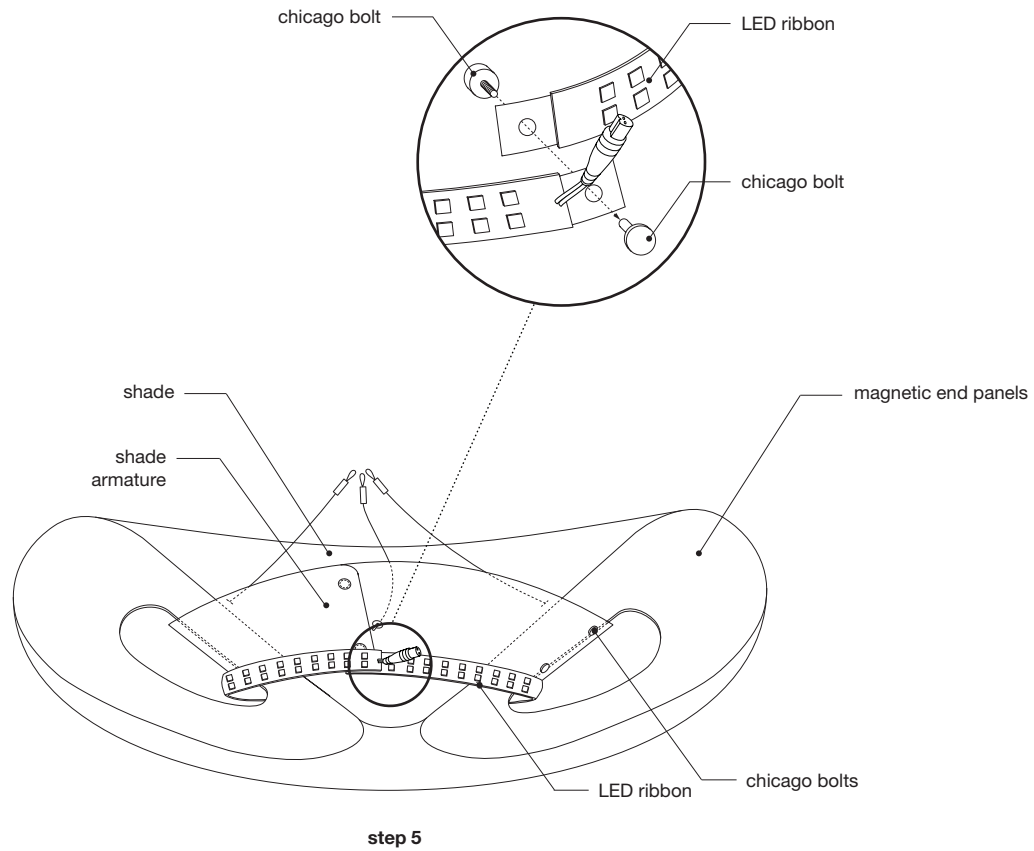

step 5: feed LED ribbon through textile shade cavity, making sure LED is under clear plastic armature. Connect the ends of the LED strip together to form a ring making sure the LED chips face outwards, and fasten with aluminum chicago bolt provided.

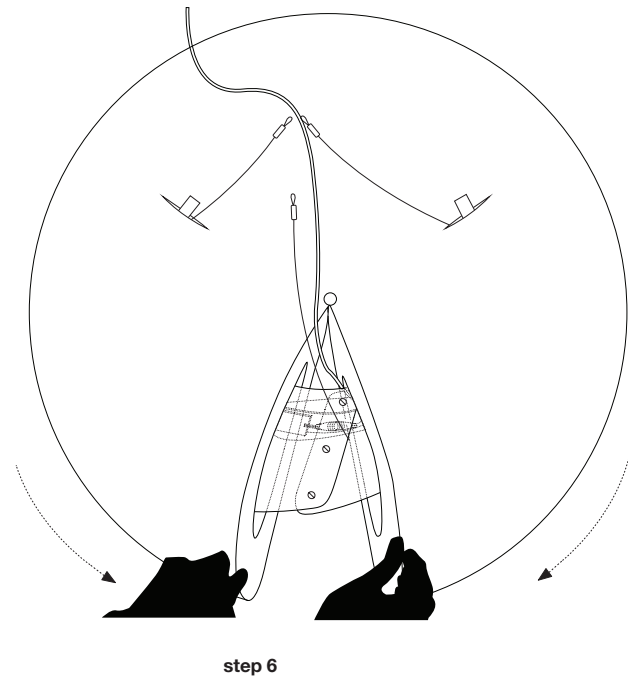

step 6: close the shade around the armature by holding inside the shade cavity and pulling the magnetic end panels around to connect one another. The magnets hold the end panels together. The third steel support cable and electrical wire are sandwiched between the two magnetic end panels.

assembling medium cloud mobile · 220-240V hardwire type (EU)

attach cloud shades

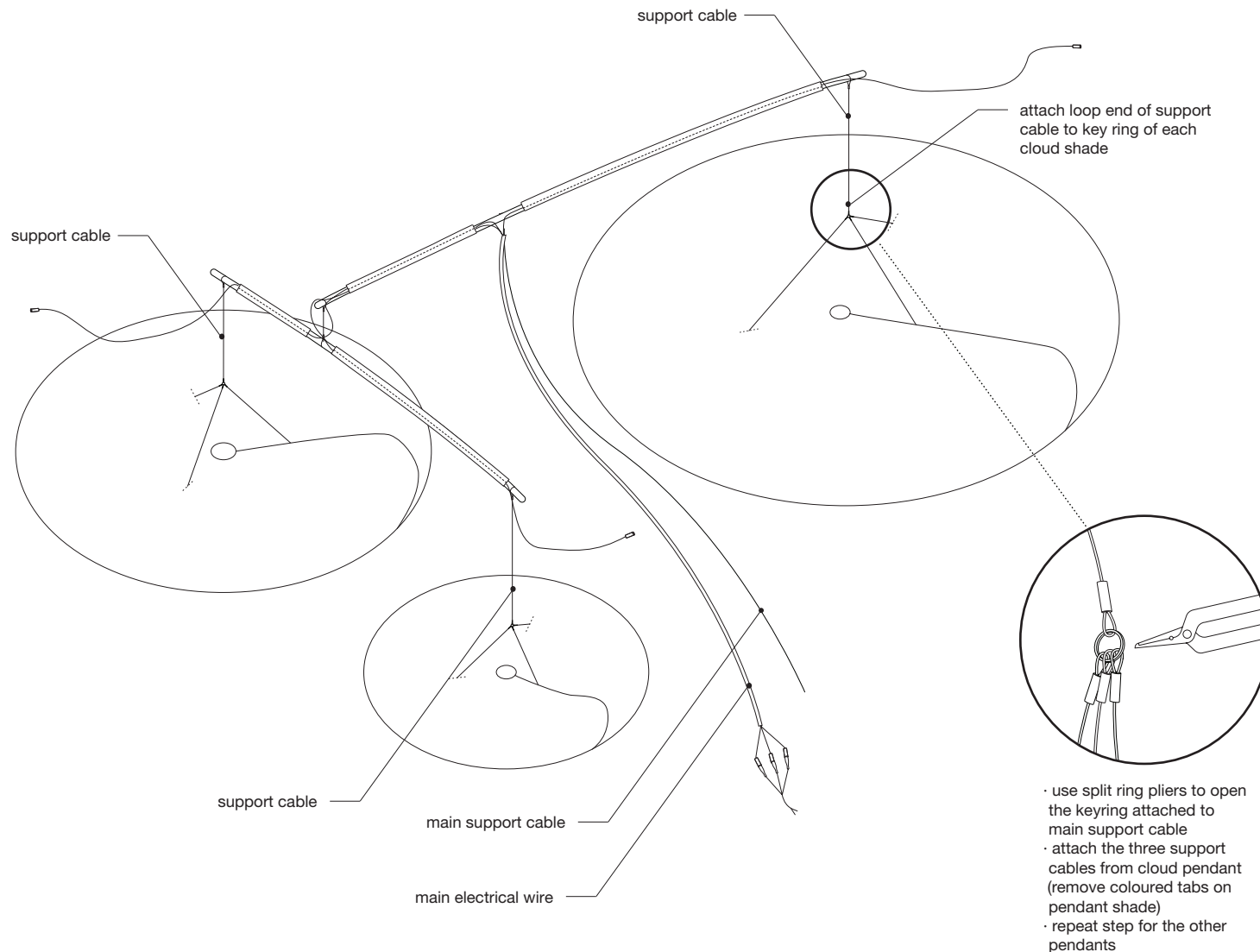

assembling medium cloud mobile · 220-240V hardwire type (EU)

connecting electrical wire to LED ribbon

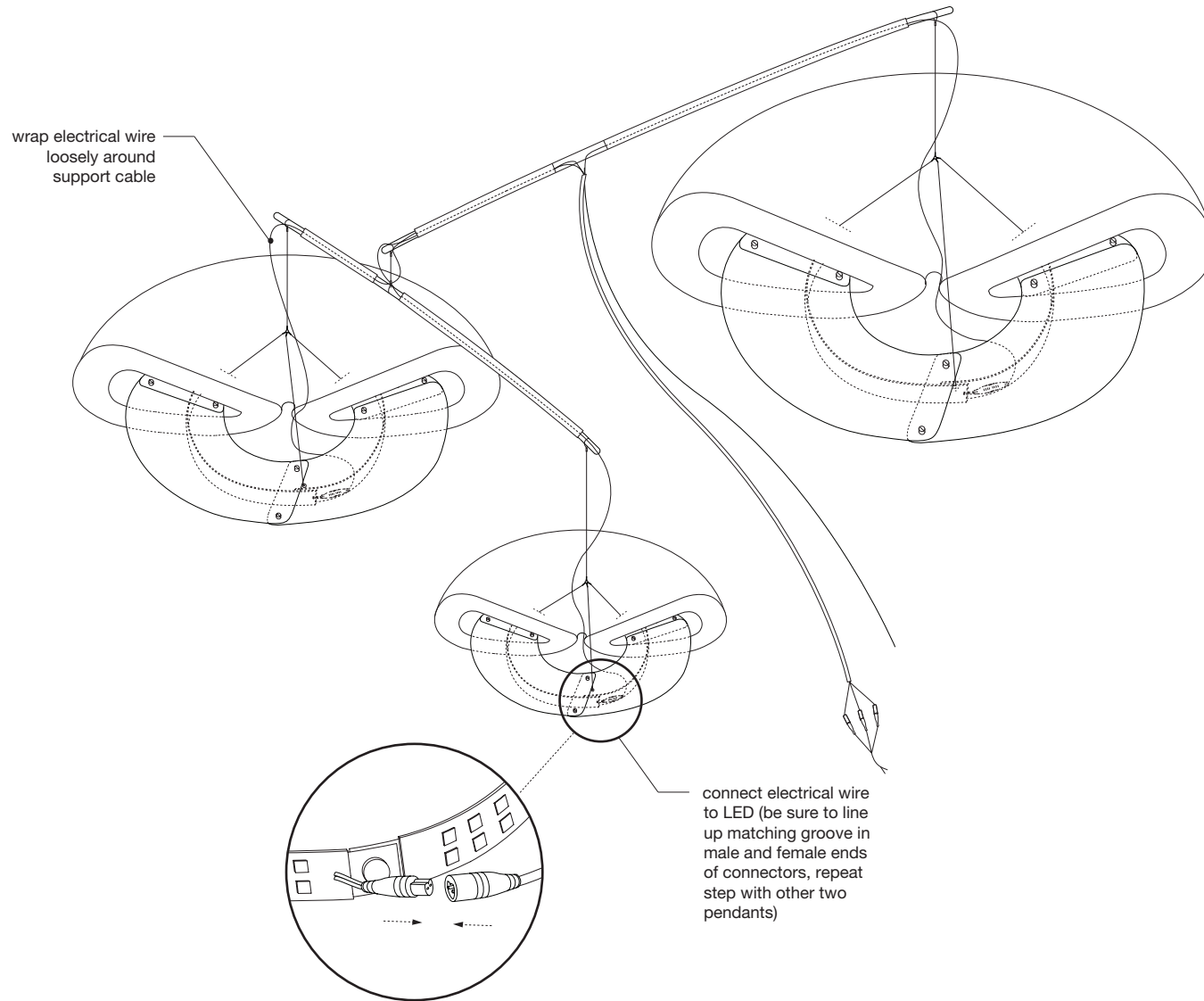

installing medium cloud mobile · 220-240V hardwire type (EU)

prepare junction box, transformer and dimmer

- bolt bracket bar with cable gripper to junction box
- junction box supplied by customer must be properly installed to support the weight of the medium cloud softlight mobile
- medium mobile - 6.0kg (13.2lbs)

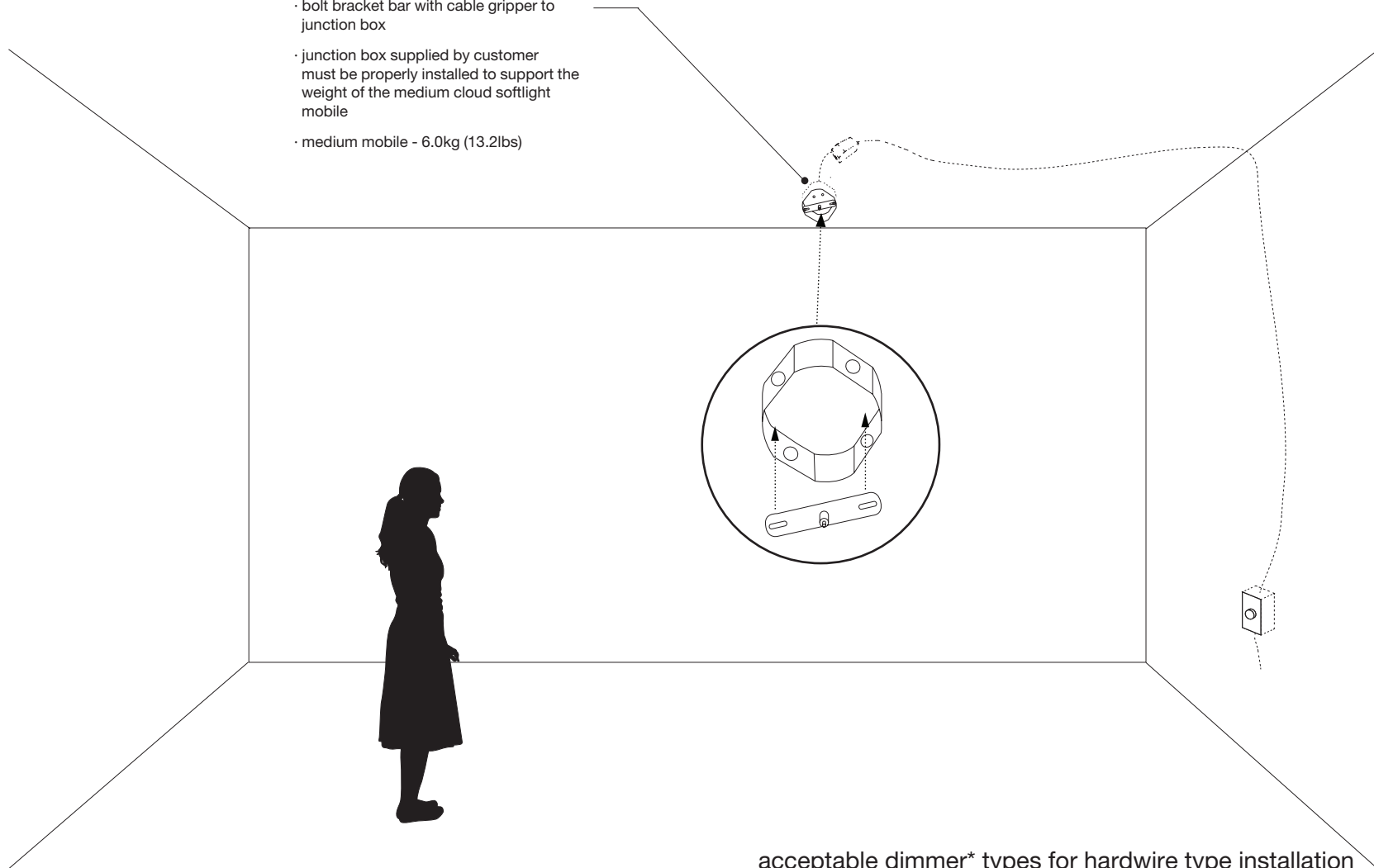

acceptable dimmer* types for hardwire type installation

- Magnetic low-voltage lighting dimmers (MLV)

*dimmer not included with hardwire type cloud softlight
(these are conventional, easy to find dimmers)

installing medium cloud mobile · 220-240V hardwire type (EU)

preparing for canopy plate installation · mounting steel washers to ceiling

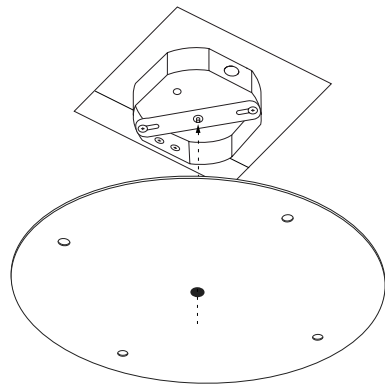

step 1

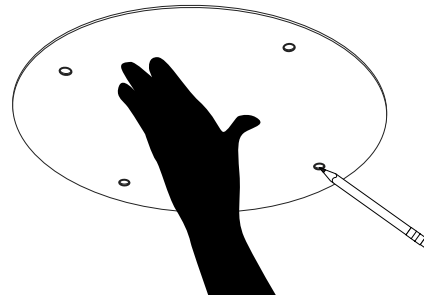

step 2

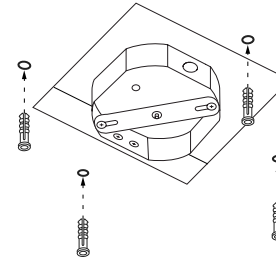

step 3

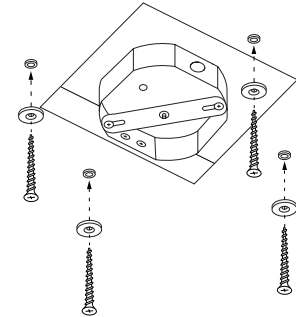

step 4

marking placement of screws

step 1: Line up the center of the provided template with the center of the junction box.

step 2: Hold the template in place and mark a dot on the ceiling through the 4 perimeter die cut holes.

mounting steel washers

step 3: Prepare ceiling to accept screws (depending on ceiling type use drywall anchors, concrete anchors, etc as appropriate).

step 4: Mount the provided steel washers to ceiling using the flat head screws. Ensure that the screw is countersunk in the washer. These steel washers will be connection points for the magnetic fasteners of the canopy plate.

installing medium cloud mobile · 220-240V hardwire type (EU)

support mobile by cable gripper

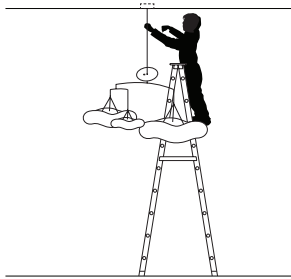
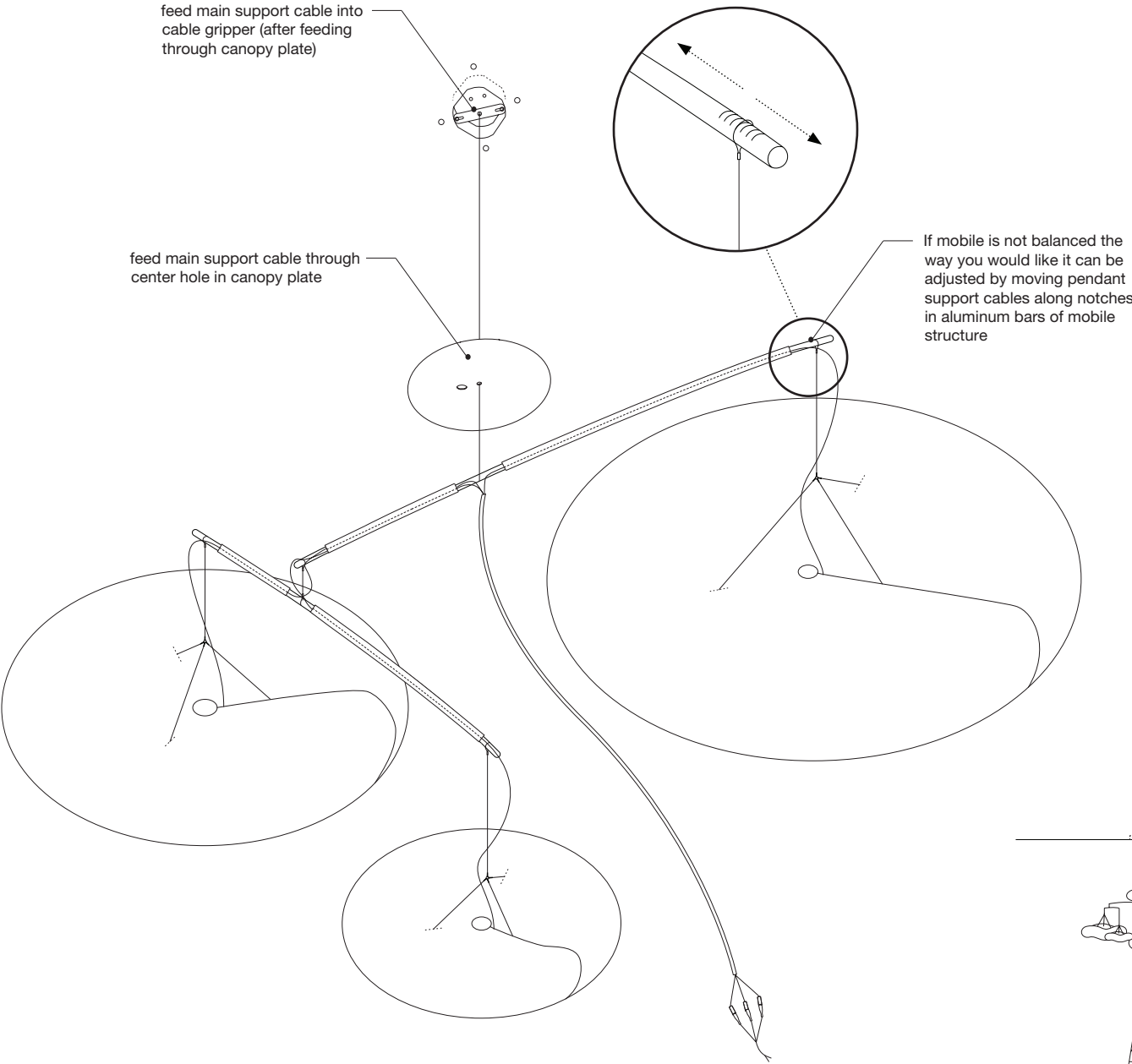

lift mobile and hang from cable gripper

installing medium cloud mobile · 220-240V hardwire type (EU)

support mobile by cable gripper + set to desired height

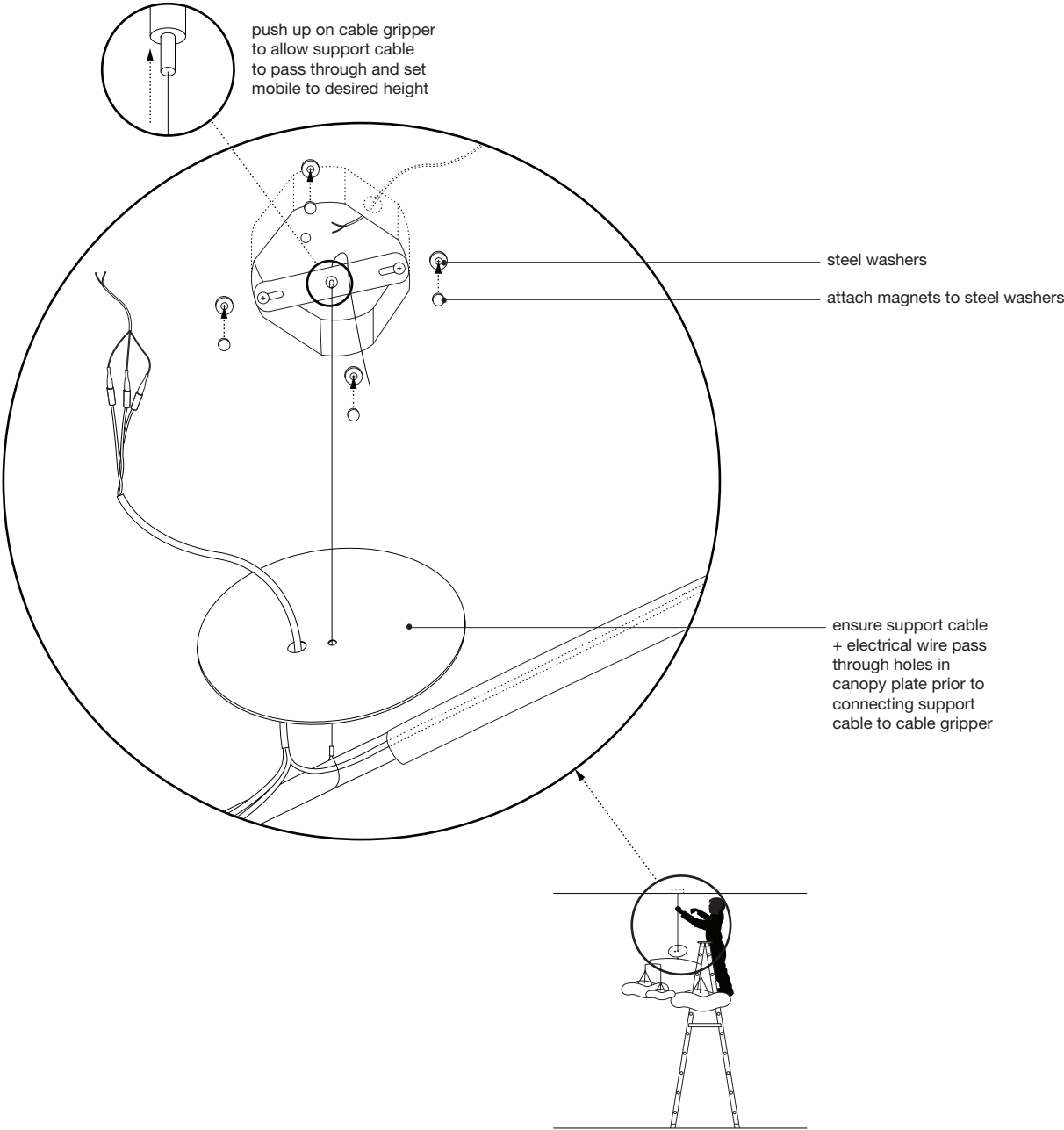

installing medium cloud mobile · 220-240V hardwire type (EU)

connect electrical

